

# SNAP18 MODULE

## ASSEMBLY OF MODULE INTO DRILL BODY

### Explanation individual parts

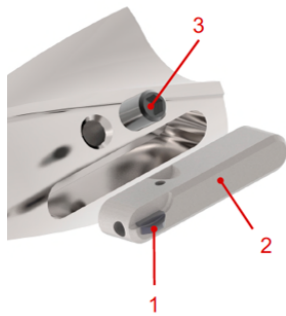

- 1** Blade
- 2** SNAP18 Module (referred as "module" in the following instructions)
- 3** Fixing screw M3 (with loosening lock)

**Caution:**

Replace the fixing screw after each module disassembly (blade exchange).

### Mounting

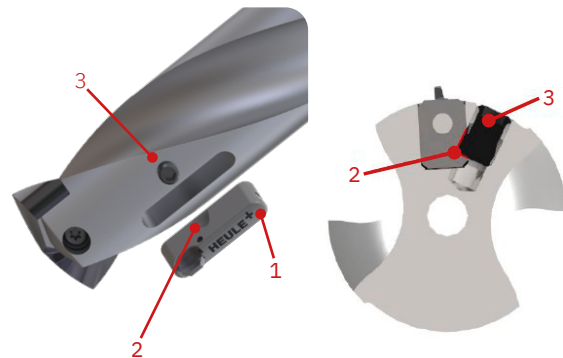

Insert the module with the mounted blade **(1)** into the drill body – the cutting edge faces the drill tip, and the screw clearance **(2)** is aligned with the screw position. Fully tighten the fastening screw **(3)** until it bottoms out and secure it with 1.5 Nm.

### Mounted modul



**Check:**

The screw **(3)** must not protrude; otherwise, the module is incorrectly installed.

### Recommended assembly tool

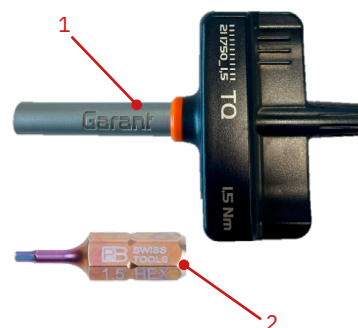

**The tool consists of 2 parts:**

**(1)** Torque screwdriver, fixed setting 1.5 Nm



**(2)** PrecisionBit for hexagon, 1/4 inch C 6.3, 1.5 mm



# SNAP18 MODULE

## REMOVAL OF MODULE FROM DRILL BODY

### Preparation



Before removing the module **(2)**, thoroughly clean the drill to remove any chips and dirt.

Loosen the fastening screw **(3)** using a suitable screwdriver.

### Removal

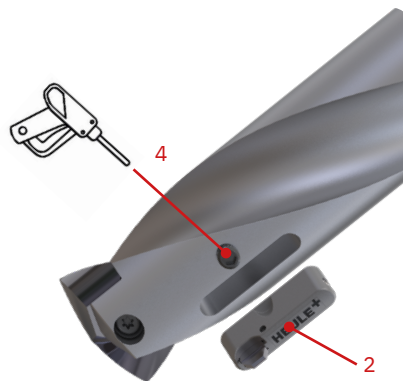

Remove the module **(2)**. If required, a gentle blast of air through the fastening screw bore using an air gun **(4)** can be helpful.

### Cleaning



Thoroughly clean the module seat **(5)** in the drill and the module **(2)** to remove any chips and dirt.